

Consoles

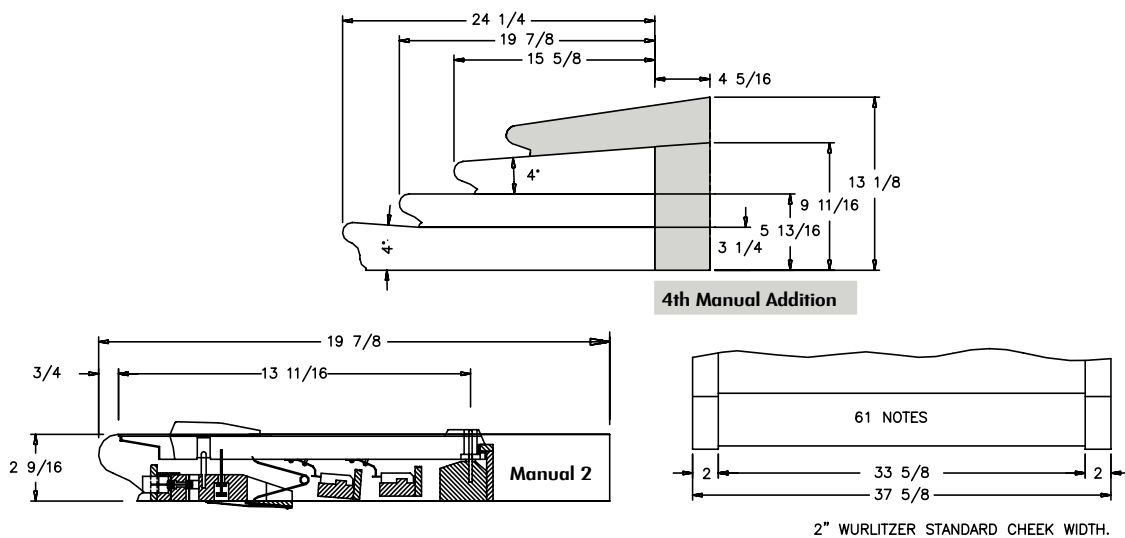

Keyboards

Organ Supply Industries is the only supplier of American-made laminated wood-based manual keyboards. These superior quality keyboards provide maximum stability and quality “feel.” The basswood laminated (Pat. Applied for) key construction provides twist- and warp-free keyboards. The relaxed sharp key spacing offers a more comfortable playing surface. (165.20 mm center to center.) Hardwood frames with adjustable front “bat” pins, fully bushed bearing surfaces, and 13-23/32” long key with a rear fulcrum construction round out the Theatre Organ keyboards. These are real wood keyboards designed for our American climate



WurliTzer™ Music Rack

Music racks are provided in wood veneers on MDF base with or without lip. Ornate and traditional styles available. Unfinished or finished to sample

- 0005.20** Style 1
1/2" T x 31" W x 13-1/8" H, 1-3/4" D lip

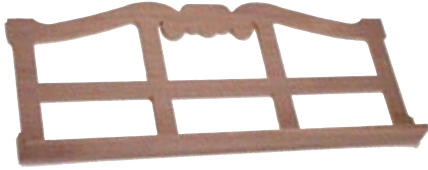

- 0005.21** Style 2
1/2" T x 31" W x 11-7/8" H, 1-3/4" D lip

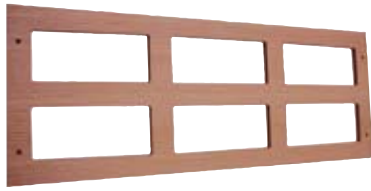

WurliTzer™ Style Music Rack Brackets

Ornate and traditional style brackets provided in wood veneers on MDF base. Unfinished or finished to sample

- 0012.20** Style 1 (pair)
3/4" T x 12-7/8" L x 11-1/8" H (nom)



- 0012.21** Style 2 (pair)
3/4" T x 12-7/8" L x 11-1/8" H (nom)



WurliTzer™ Style Manual Keys, Unmounted

- 0200.20** Unmounted 61 note manual keys on maple frame, furnished with synthetic coverings. Order hardware and felts separately.
13-23/32" front to fulcrum pin,
14-9/16" overall front to back.
33-9/16" W C-C



WurliTzer™ Style Manual Keys, Mounted

- 0203.00** Mounted with WurliTzer™ Mahogany key cheeks and key slips. Synthetic key coverings. Equipped with compass key tension springs, adjustable up stop, front and balance rail felts, hinged at rear for service. Contact rails with 4 or 7 wire contacts installed, separate silver-tipped contact plates installed. Complete, ready to attach cables.



Manual 1



Manual 2-4

Additional services include finishing to sample, engraving and installing combination and second touch. Satin synthetic and bone coverings are available, as are special key cheek shapes.

0210.00 WurliTzer™ 2nd Touch Spring

3-1/4" L, 3/8" W x .035" T



WurliTzer™ Hammer Rail Felt

- 6110.00** Manual Hammer Rail Felt Without 2nd Touch
6110.10 Manual Hammer Rail Felt For 2nd Touch

Manual Key Compass Spring

7200.01 1-7/8" L x .040 Ø Wire



Manual Contact Blocks

0220.24 4-wire
0220.27 7-wire

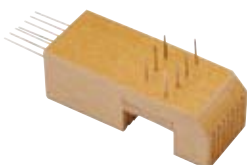

Replacement WurliTzer™ Manual Piston Rails and Slips

0220.40 Replacement rails and slips are faithful reproductions of the WurliTzer™ originals including the "preferred" feel. They set the standard for all theater organs. Second touch available upon request.

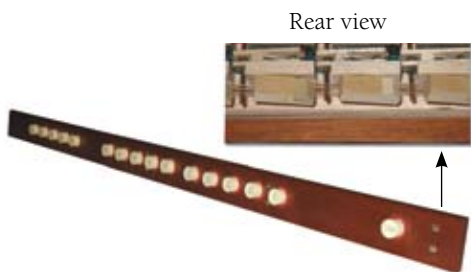

WurliTzer™ Manual Piston Components

0203.50 Thumb Pistons Toggle
0203.51 Brass Coupler
0203.52 Pivot Pin
0203.53 Contact Pin
0203.54 Manual Piston Spring
0090.00 Piston Head, engraved

0220.21 Piston contact block, 2-wire
0220.23 Piston contact block, 3-wire

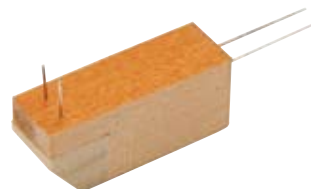

Push Button Momentary, Lighted (optional)

Single Pole, Double Throw push button ideal for advanced Control System features and miscellaneous organ peripherals. Low profile tactile feel. 12 VDC or 28 VDC Operation. Bore for 27/32" hole.

1.15" L x .930" Ø

0180.10 Switch w/ Lens, Blank
0180.11 Switch w/ Lens, Engraved

0180.51 12 VDC, Lamp
0180.52 28 VDC, Lamp



PEDALBOARDS

Pedalboards, built to AGO specifications, are provided in 32 note compass with WurliTzer™ appearance. Standard Style No. 1 frame side rails are perpendicular to floor with special flush mounted feet. Extended toe rail for WurliTzer™ swell shoe mounting. Includes WurliTzer™ naturals & sharps. Key bodies are constructed of straight grained white oak. Keys are guided by a 3/16" rod running through a felt bushed slot in the key front. Easily adjusted flat bent carbon steel tension springs are fastened to solid oak heel rail. Natural key caps are straight grained select hard maple, finished with durable clear epoxy lacquer. Pedalboards are constructed for hard usage and stability, with specially formed and veneered ply curve front top rail and hammer rail.

Additional services include: finishing to sample, mounting contact bar (4 to 12 wires) with silver-tipped contact plates, mounting toe pistons with nameplates and 2nd touch. Contact plates with pigtails are also available.

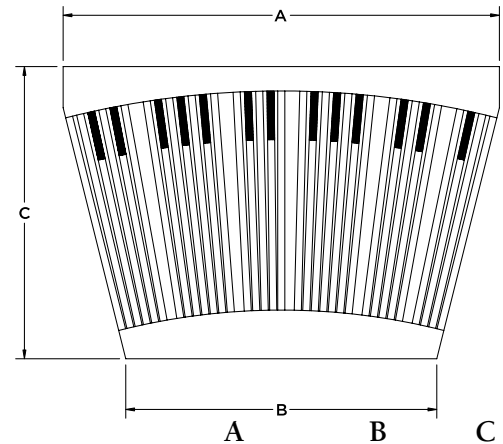

OSI WurliTzer™ Style 53-3/4" 36-3/4" 36"

Shipping Weight: 135 lbs.

- 0301.21 Birch
- 0303.21 Mahogany
- 0308.21 Walnut

Pedal Key 2nd Touch

- 0301.20 Second touch is available installed on new pedal keyboards or can be retrofitted on existing OSI pedal keyboards. Mechanism provides consistent, quiet and firm stop and smooth, positive tactile feedback beyond the engagement point.

WurliTzer™ Bench

- 0500.11 Faithful reproduction and sturdy construction from your choice of birch, mahogany or walnut. Available unfinished or finished to sample.



Pedal Keyboard Naturals

WurliTzer™ replacement naturals. Clear rock maple naturals are finished in a clear epoxy lacquer. Available in specified lengths.



- 0310.60** WurliTzer™ Pedal Natural
1" W x 1" H x 21" L

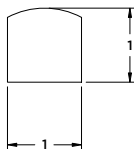

WurliTzer™ Pedal Sharps



- 0313.15** WurliTzer™ replacement sharps, ebony capped for original or OSI WurliTzer Style Pedalboards.
1" W x 2-1/2" H x 5-1/2" L at base

WurliTzer™ Pedal Contact Block

- 0320.24** Pedal contact block, 4-wire
0320.27 Pedal contact block, 7-wire
0320.32 Pedal contact block, 12-wire

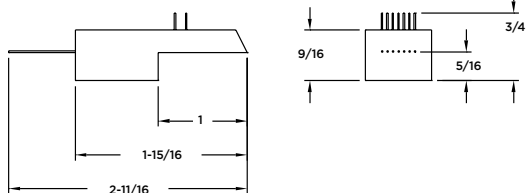

WurliTzer™ Friction Blocks and Swell Shoe Contact

- 0320.40** Long Stroke
0320.41 Short Stroke



- 0320.42** Expression contact block, 13-wire

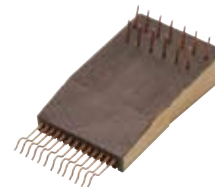

WurliTzer™ Toe Piston

- 0403.01** Authentic WurliTzer™ Toe Piston, chrome plated with logo. Dust-free enclosed switch.



Sostenuto Kick Switch

- 0425.00** Designed to mount on a variety of expression shoes. Durable Nickel plated steel frame. Enclosed switch provides spring tension.



1-1/2 W x 2-3/4" H x 1-1/2" D

- 0425.10** Spacer for Sostenuto Switch for height adjustment when Installed on WurliTzer™ Swell Shoes.

1-5/8" L x 1/2" W x 5/8" D

WurliTzer™ Unit Chests

1225.00 WurliTzer™ manual unit chests are constructed using original layouts and factory details. The distinctive parts that make these high pressure chests the standard of the theatre organ are authentically reproduced. Chests are constructed as individual units or several stops on a common frame with appropriate wind manifold. Your choice of reliable Reisner chest magnets or rebuilt WurliTzer™ magnets are available. All chests are provided in original shellac finish.

Offset chests for 8' and 16' basses are available in original configurations or custom built to your specifications.

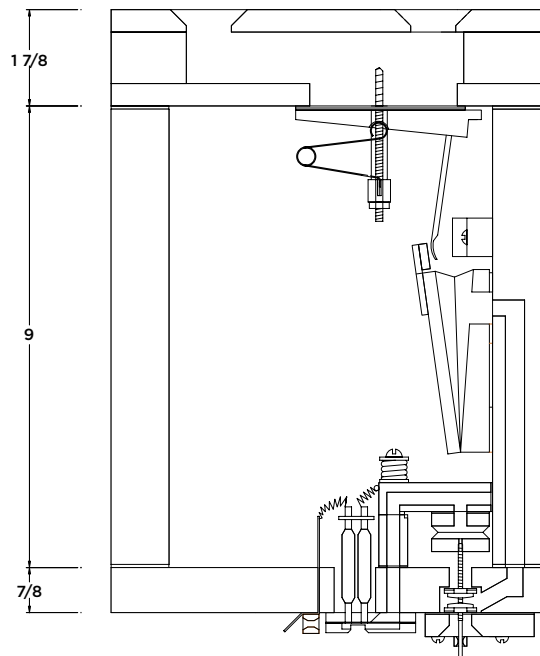

7200.30 WurliTzer™ Chest Pallet Spring



WurliTzer™ Manual Chest Pallets with Spoons, Leathered Complete

6960.02 2-5/8" x 7/16"
6960.04 2-5/8" x 5/8"
6991.02 3-5/8" x 7/16"
6991.03 3-5/8" x 9/16"
6991.04 3-5/8" x 5/8"
6991.05 3-5/8" x 3/4"

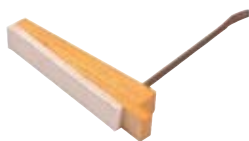

6975.13 3/4" x 1-1/8"

Primary Pneumatics, WurliTzer™ Manual Chest

Primary pneumatics are covered in first quality extra thin tan pneumatic leather. The leather is silicone treated for longer life. The wood blocks are 1/4" thick. One side is drilled with a No. 50 Ø hole for a standard 13 ga. Valve wire. The other face has a 3/8" Ø hold and has a leather gasket on the mounting face.

WurliTzer™ Pallet Leather

Layered Valve leather glued together with smooth face out, duplicating original pallet covering. Furnished in strips of varying length. Order by total length required.

Strip Width	Use
6520.01 2-5/16"	Manual Chests
6520.02 3-5/16"	Manual Chests
6520.03 2-7/8"	Offset Chests
6520.04 5-5/8"	Offset Chests
6520.05 6-5/8"	Offset Chests

WurliTzer™ Secondary Motor Gaskets

Each size shipped with punching (not shown) for mounting on hinge end of pneumatic.

6980.05 For 13/16" and 1-1/8" Motors
6980.06 For 1-1/4" and 1-3/8" Motors



WurliTzer™ Secondary Motors

These manual chest motors are time saving alternative for rebuilding or re-leathering. The pine blanks are exact duplicates of the originals and are furnished with maple “spoon” tabs and hinges ready to leather. Grain orientation has been carefully duplicated. Leather, felt, gaskets, screws, and escutcheon pins are available separately.

3-1/2” L

Blanks	Leathered Complete	Width
6980.01	6980.51	13/16”
6980.02	6980.52	1-1/8”
6980.03	6980.53	1-1/4”
6980.04	6980.54	1-3/8”



6980.15 WurliTzer™ Spoon Tab



7502.02 Round Head Wood Screws
#2 x 3/8”

7317.01 Escutcheon Pins #17 x 3/8”

6112.00 WurliTzer™ Spoon
Tab Felt
5/32” x 1/2” x 55”

WurliTzer™ Primary Valves

These original design WurliTzer™ leather, fibre, and leather punching primary valves are available for replacement of existing primary valves. The 5/8” Ø valve is the integrated, self-threading style. It is completely assembled and ready to install on valve wire without additional leather nuts.

The leather and fibre primary valve with center hole is also available. Assembly on the valve wire requires two leather nuts per valve. Provided with No. 37 drill hole in fibre, pin hole in leather.

The complete valve wire assembly consists of two self-threading 5/8” Ø valves installed on 2-1/4” Long 13 ga. Plated valve wire.

6850.08 WurliTzer™ self-tapping primary valve, 5/8”



6851.08 WurliTzer™ primary assembly



6850.18 WurliTzer™ plain primary valve, 5/8”



Manual Chest Magnet Board Screws

- 7701.15** 12-24 x 2", RH Slotted
7701.18 12-24 x 2-1/2", RH Slotted

Threaded Inserts

Use as a replacement for WurliTzer™ Chest inserts. Allows for convenient, efficient, and frequent removal of chest parts. Secure fit for existing WurliTzer™ stripped inserts knife thread. No tapping required.

.453" O.D. x 1/2" L

	I.D. Thread	Drive Material	Tool
7710.16	12-24	Plated Steel	8246.10



Threaded Insert Drive Tool

Recommended for installation of threaded inserts, these drive tools provide more positive engagement and efficient installation of inserts. Fits standard hex socket, most screw guns, or can be chucked in reversible drill

	Insert Size	L
8246.10	10-24 & 10-32 & 12-24	1-7/8"



WurliTzer™ Primary Action Box

- 1225.20** Replacement for a variety of existing WurliTzer™ Offset Primary Actions and Tremolos. Unit complete with rebuilt WurliTzer™ magnet and primary.

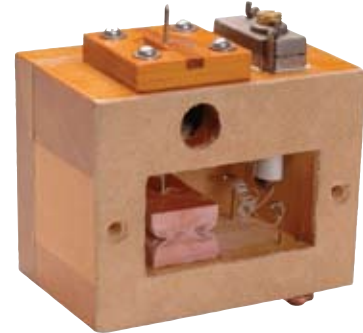

WurliTzer™ 12 Note Treble Extension Chest

- 1310.00** Chests for treble extension pipes that must be offset can be provided in one or more sections. Bottom bung construction. Primaries are not included.



Percussion Pneumatic Batten

Pneumatic Batten strips constructed from White Maple.

- 1660.01** 24" L x 3/8" W x 1/8" T
1660.02 24" L x 7/16" W x 1/8" T

WurliTzer™ Regulators

WurliTzer™ style reservoirs are complete with one cone valve and two book or pallet valves. Ready to install on standard WurliTzer™ wind trunks. Four (4) long spring bars are furnished with each unit. Additional spring bars and coil springs are available.

	Size	Shipping Weight
2072.00	20" x 30"	48 lbs.
2073.00	26" x 35"	71 lbs.
2074.00	32" x 35"	97 lbs.
2075.00	35" x 42"	126 lbs.

2072.58	Short spring bars 5" (maple)
2072.59	Long spring bars 10" (maple)

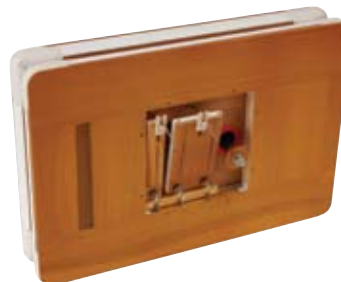

Wind Trunks

	Size	Capacity
2073.14	14" x 14" x 14"	1 Regulator
2073.44	14" x 14" x 44"	2 Regulator
2073.66	14" x 14" x 66"	3 Regulator

WurliTzer™ Regulator Valve Plate Assembly

	Size
2072.40	20" x 30"
2073.40	26" x 35" / 32" x 35"
2075.40	35" x 42"

Regulator Gussets, WurliTzer™

Cut and skived leather corner gussets. Set of 4 with 8 patches.

2072.57	Gussets, all sizes
2072.65	Patches
2072.66	Corner Caps
2072.67	Bellows Strips, 1-5/8"

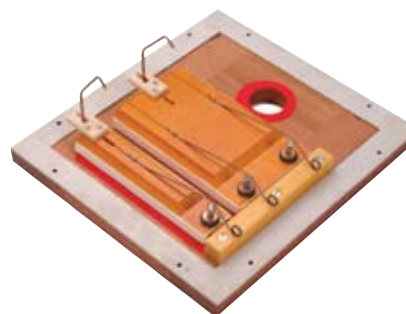

2072.41 Bell Valve Assembly



WurliTzer™ Equalizer

WurliTzer™ originally designed these units as pressure regulators for swell shutter, console, and percussion actions. These hinged units employ a sophisticated cone valve and are an economical alternative to a standard reservoir where space is at a premium and critical regulation is not required. Suggested for pressures over 5". The 3" inlet and 3" outlet are located on the bottom of the unit. 15" H O.A.



	W x L	Shipping Weight
--	-------	-----------------

2080.08	8" x 20"	15 lbs.
2080.10	10" x 24"	23 lbs.

2080.75 4 Legs, 17"

2080.41 Cone Valve Assembly



3305.01 WurliTzer™ Shutter Spring Fibre Link



7250.10 WurliTzer™ Shutter Spring



5-3/8" L O.A.
.625" Ø O.D.

Power Pack 2000

5006.01 12 V / 65 A
5006.02 12 V / 120 A
5006.03 24 V / 65 A

Surge tolerant power source and energy monitor, which utilizes maintenance free self-charging batteries. Computer monitored output can supply the specified in-rush currents with no leaking or venting and fault protection built-in.

9.875" L x 6.750" W x 7.625" H
105 - 128 VAC, 60 hz Maximum -
48 Watts Trip Current Range from
0.3 Amps to 1.8 Amps



DC Logic 5 Volt Regulated Converter

5008.00 DC converter for applications that require well regulated logic supply. Small size, easy mounting, efficient operation reduces heat and bulk of traditional linear power supplies.

5-1/2" L x 2-1/2" W x 2" H
Input 10 VDC (min) - 30 VDC (max)
Output 5 Volt DC Regulated at 3 Amps



WurliTzer™ Chest Magnets

- 5500.40** 180 Ohm, Zinc Die Cast, Rebuilt
5500.42 180 Ohm, Phenolic, Black Cap Style, Rebuilt
5500.95 180 Ohm, Customer Magnet Rebuilt at OSI

WurliTzer™ Chest Magnet Parts

Chest magnet coils are wound on 1-3/4" long bobbins to fit WurliTzer™, Reisner, OSI, or any 5/32" Ø magnet core. They are provided in pairs with standard 6" lead wires, ready to install.

- 5500.61** 90 Ohm
5500.62 125 Ohm
5500.63 150 Ohm
5500.64 180 Ohm
5500.65 200 Ohm



- 5500.76** WurliTzer™ chest magnet cap (self-adhesive) gasket.



- 5500.77** WurliTzer™ chest magnet base (self-adhesive) gasket.



- 5500.85** WurliTzer™ armature, electro-plated .036" T x .450" Ø



- 5500.90** WurliTzer™ Chest Magnet Dag Screw 1-5/16" L x 3/8" W x 3/32" Ø



- 5500.91** WurliTzer™ Magnet Thru Wire



- 5503.70** Robert Morton Magnet Gasket



Reisner Player Piano Magnet

- 5909.14** Designed to interface with piano and other vacuum actions. 1/8" brass nipple accommodates standard piano tubing and extends 1/2" from magnet.

60 Ohm



7700.20 WurliTzer™ Percussion Cleats, Steel

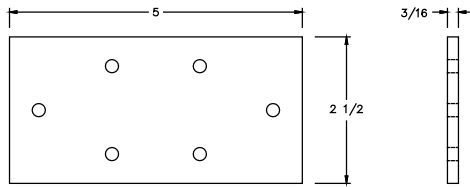

6 SCREW HOLES FOR NO. 12 SCREW

Wind Chimes

Wind chime models are available with 3/8", 1/2 or 3/4" solid aluminum chime bars of varying length. Rotation speed controlled by on board potentiometer. Direction is switch selectable to create ascending or descending passages. Volume easily regulated by striker height. Solid State control allows for latch stop control on existing or new installations. Sizes are available for "best fit" depending on room size and location. The small size is suitable for more intimate installations, whereas the larger sizes are better suited for larger rooms and theatres.

Operating voltage 10 to 16 VDC, 5ADC, 5 Amp. 12-7/8" H O.A.

	Description	Top Ø
8508.10	Small, 3/8" Chimes	10-1/2"
8508.20	Medium, 1/2" Chimes	12-1/16"
8508.30	Large, 3/4" Chimes	16-7/32"



PIPES

Organ Supply Industries is justly proud of the high quality, American-made pipework we provide for our customers. Each pipe is carefully crafted to your specifications by our experienced pipe makers in our workshop, then meticulously voiced to your instructions.

MITERING

Where sufficient height is not available, pipes can be mitered up to 180°. 90° miters are made with two cuts and 180° miters have four cuts and are securely braced. Good organ building practice suggests that the miter start no lower than 2/3 of body length. If a shorter pipe is required, a Haskell or stopped bass is an alternative.

STANDARD PIPE CONSTRUCTION

Standard pipe construction includes zinc pipes with Gothic mouths, slide tuners or caps, finished in standard aluminum lacquer. Spotted metal pipes have pressed down (flattened) mouths and slide tuners or caps. All standard pipe work employs and appropriate halving ration, 58° languid level, and standard feet.

Wood pipes are constructed from top quality, clear poplar with hardwood windways and caps. They are provided unfinished, or finished clear lacquer, WurliTzer™ shellac, brown stain, or to a color sample. Wood pipes are available in most wood species and to custom scales.

Reed pipes are built from spotted metal (50% tin). Resonators longer than 2' C on Trumpets and Oboes are traditionally of two piece construction with spotted metal bells and zinc stems. Full length spotted metal resonators can be provided for 8' reeds. Full length 16' octaves are made from zinc with spotted metal tuner inserts. Spotted metal bells can be provided. Common metal or antimonial lead can be used in place of spotted metal.

CUSTOM PIPE CONSTRUCTION

All flue pipework is handcrafted in our plant. Customer to provide special scaling and special constructions are easily accommodated to your specifications for any flue pipework.

Treble Pipes

9075.02 When an existing stop is to be extended by several notes or several octaves, where possible, stock treble spotted metal pipes, complete with slide tuners, are used. Matching pipes of spotted metal, common metal, or 75% tin can be provided. For best tonal and scaling match, the last existing pipe and wind pressure on which it is voiced should be furnished.

Pipe Repair

Our pipe shop is equipped to repair individual damaged metal flue pipes or to provide faithful replacement pipes for those missing from an incomplete set. When a pipe is to be repaired or replaced, the pipe on either side of the damaged or missing pipe is essential, along with operating wind pressure, so that a proper match for both scaling and voicing can be obtained. Pricing can be furnished after inspection of pipes to be repaired or replaced.

9035.00 Metal Flue, Repair
9135.00 Reed Pipe, Repair
9235.00 Wood Pipe, Repair

Revoicing

Older flue and reed pipes in good physical condition can often be recycled and revoiced at a savings. Pipes will be accepted for revoicing provided they are of good manufacture, show no metal fatigue, and are not badly torn or mishandled. Pipes are washed and minor repairs are made. For flues, new tuning slides are installed as required and pipes are revoiced consistent with new tonal requirements, wind pressure, and customer instructions. For reeds, tuning wires are replaced as required and new tongues provided consistent with new tonal requirements wind pressure and customer instructions. Changing shallot styles is not recommended.

9030.00 Metal Flue, Revoice
9130.00 Reed Pipe, Revoice
9230.00 Wood Pipe, Revoice



WurliTzer™ Tibia Treble Pipes

WurliTzer™ replacement treble pipe for 10" and 15" scale 8' Tibia available in Antimonial lead. These pipes are capped metal #50-55 and open from #56-85. Pipes provided voiced to your samples.



9080.50 #50-61

9080.62 #62-73

9080.74 #74-85

9166.00 WurliTzer™ Special Reed Shallots



Tuba

Orch.
Oboe

Kinura

9200.90 Wood Toe Pipe Feet

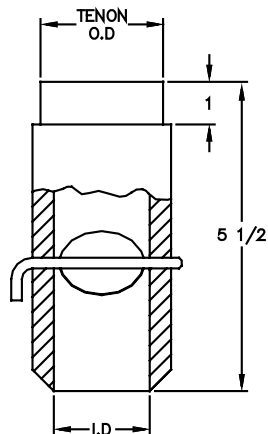

STYLE	I.D.	TENON O.D.
1	1	1 1/2
2	1 1/4	1 3/4
3	1 1/2	2
4	1 7/8	2 7/16

Metal Flue Pipes

	Pitch/Stop	Scale	Halving	Number of Pipes Zinc	S.M.
10800.00	8' Open Diapason	43	18	12	49
	8' Diaphonic Diapason	44	18	12	49
	8' Horn Diapason	43	18	12	49

Wood Flue Pipes

	Pitch/Stop	Scale	Number of Pipes Wood	S.M.
70800.00	8' Tibia	10"	49	12
	8' Tibia	15"	49	12

Reed Pipes

	Pitch/Stop	Scale	Number of Pipes Reeds	S.M.
80809.00	8' English Post Horn	Gottfried	49	12
80800.00	8' Tuba Horn	5"	61	
	8' Harmonic Tuba	5"	61	
	8' Tuba Mirabilis	6-1/2"	61	
80802.00	8' Oboe Horn	3-1/2"	56	5
	8' Orchestral Oboe	1-7/16"	56	5
80817.00	8' Saxophone	4"	49	12
80814.00	8' Krummet	2"	56	5
80803.00	8' Clarinet	2-1/4"	56	5
80808.00	8' Vox Humana	1-5/8"	56	5
80818.00	8' Kinura	1-1/2"	61	